

Dashed red line denotes position of optional 18mm baffle overhang to cover speaker - wall joint in soffit mount installations

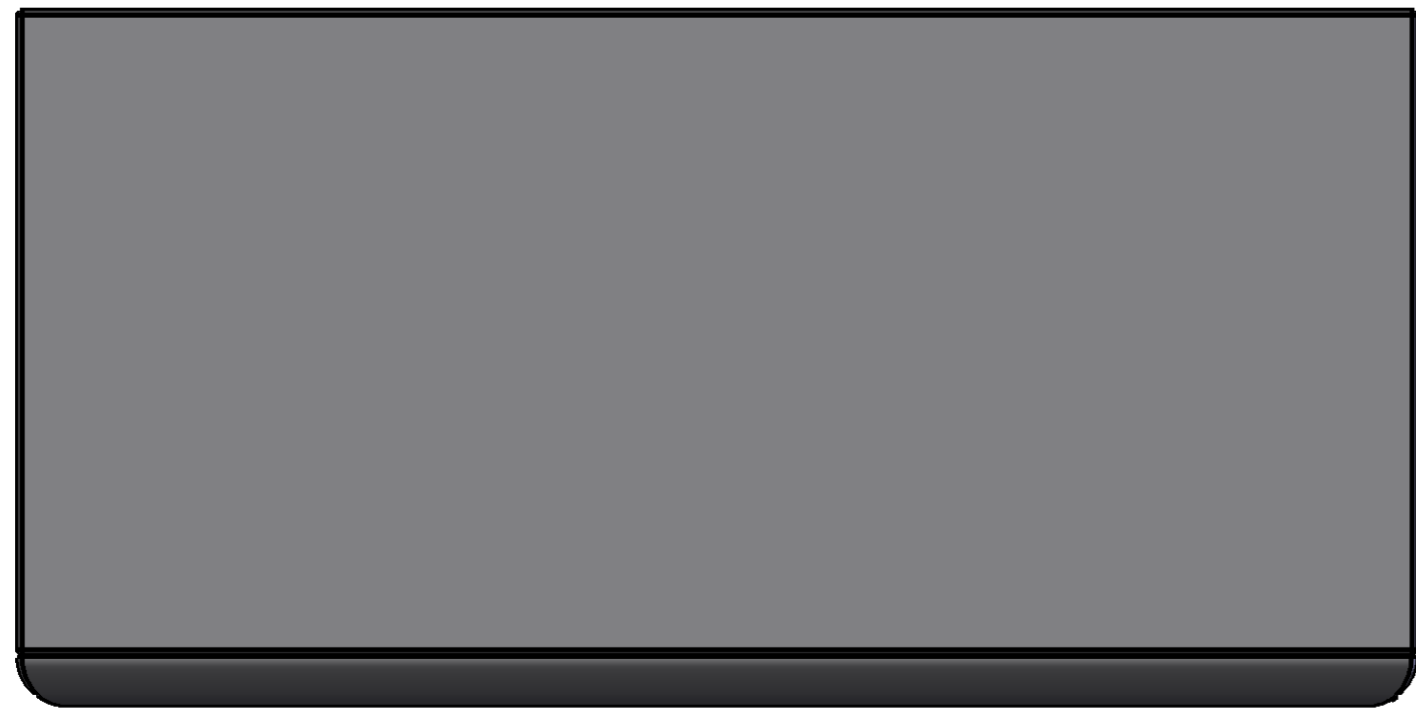

**NOTES**

1. STEREO SPEAKERS ARE BUILT AS MIRROR IMAGE PAIRS
2. CENTRE TYPE SPEAKER HAS MID AND HF DRIVERS HORIZONTALLY CENTRED ON THE BAFFLE. VERTICAL POSITION AS LEFT/RIGHT CABINETS.
3. DIMENSIONS SHOWN IN MM & [INCHES].

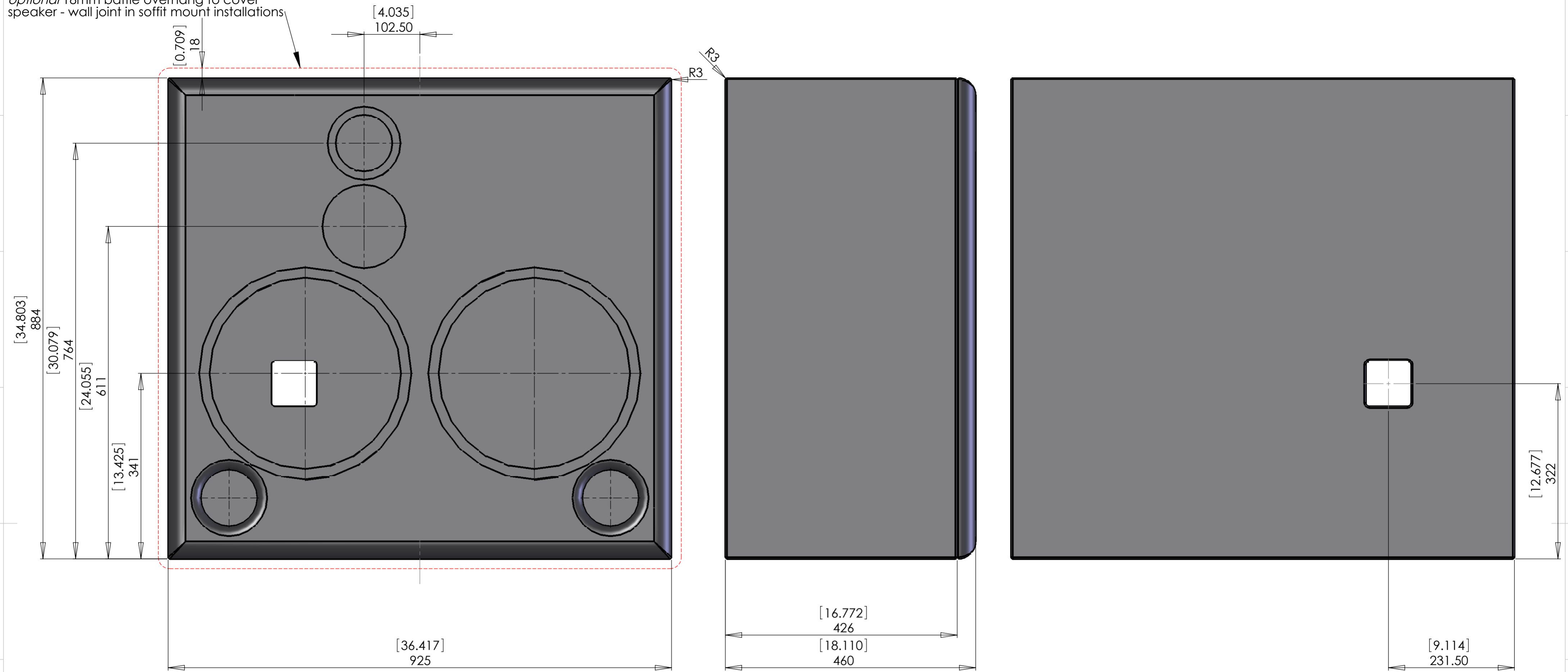

DIMENSIONS ARE IN MILLIMETERS (U.O.S)  
 SURFACE FINISH:  
 TOLERANCES:  
 LINEAR:  
 ANGULAR:  
 REMOVE SHARP EDGES

MATERIAL:  
 18MM MDF  
 FINISH:  
 CABINET - SPLATTER BLACK  
 BAFFLE - SATIN BLACK

LOUDSPEAKER TECHNOLOGY LTD  
 GYPSY LANE  
 ASTON DOWN  
 STROUD  
 GLOUCESTERSHIRE GL6 8HR  
 TELEPHONE: 01285 760561

ISSUE	DATE	DRAWN	CHKD	APPVD	REMARKS
***	***	***	***	***	***

TITLE: <b>SCM300 OUTLINE DRAWING</b>	
DWG NO. <b>NOT ISSUED</b>	A2
WEIGHT: ***	SCALE: ***
SHT 1 OF 1	